



Ropetek Hitch Hiker 2 Instruction Manual

Original Instructions: English Language

(LAST REVISED 5/2015)



Warning! Risk of death by falling. Working at elevation with ropes as the only means of support involves a risk of death.

Safe working at elevation with ropes is a complex activity. It requires proficiency in site and rope set up, and the correct selection and use of a fall protection system. The Hitch Hiker 2 is a work positioning device for use by trained rope access professionals.

If you do not know how to apply rope-work regulations from OSHA 29 CFR 1910 (or the equivalent workplace code in your jurisdiction), then you are not qualified to use the Hitch Hiker 2. North American Training Solutions (888 652-9166) offers training for working at height with ropes as the only means of support.

Warning! Risks of serious injury. You must read and understand ALL of the safety precautions contained in these instructions.

THIS MANUAL DOES NOT TEACH HOW TO WORK SAFELY AT HEIGHT USING ROPES FOR SUPPORT. YOU MUST BE PROFICIENT AT THIS BEFORE USING THE HITCH HIKER 2.

SPECIFICATIONS

Materials	Sideplate: Nickle coated AR400S Spine: Aluminum 4140/4142 Dogbone: 4140 Pre-hardened Steel
Minimum Breaking Strength	25 KN (5620 LBS)
Dry Weight	< 1LBS.

SERVICE INSTRUCTIONS

- Inspect device HH2 for cracks
- Confirm screws are in place and tight.

THE HH2 PARTS LIST:

- HH2 Main Body
- Dogbone
- CT Steel Carabiner



You will need to supply a length of prusik cord to use with the Hitch Hiker 2. The instructions on the following page show the original Hitch Hiker, but the process for installation is the same with the Hitch Hiker 2.

RopeTek Hitch Hiker Instructions

Part List:

- 1 Dog Bone
- 1 Hitchhiker
- 1 CT Steel Carabiner

(You will need to supply a length of prusik cord.)



1 Tie a double overhand stopper knot on the un-whipped side of the cordage. Form a loop in the cord, then pass the un-whipped end through it. Pass this end through the loop again, then tighten and dress to make a secure stopper knot.



2 Pass the whipped end of the hitch cord through one eye of the dog bone and pull the dog bone until it hits the stopper knot.

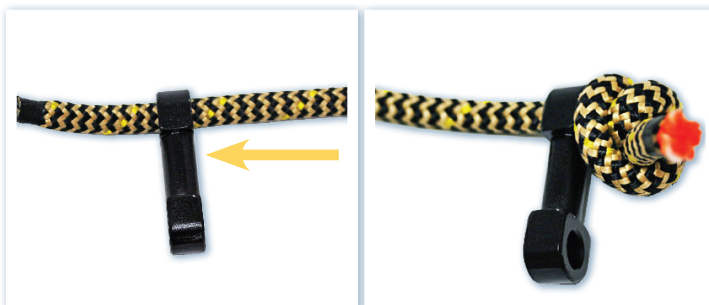

3 Place your climbing line inside the Hitch Hiker, then turn the dog bone sideways so it can insert through the upper slot of the hitchhiker. Once it is fully inserted, turn the dog bone 90 degrees to lock it into place.

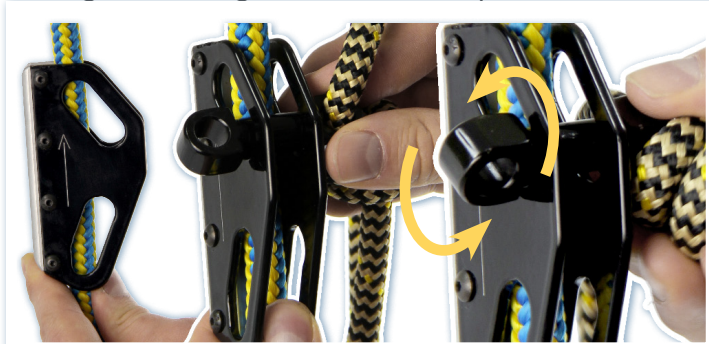

4 Begin to wrap the hitch cord around your climbing line above the hitch hiker, making sure the cord first goes around the spine side. Make 5 wraps, then put the whipped end through the dog bone.

This will make a 5 wrap prusik when accounting for the crossover to the dog bone.

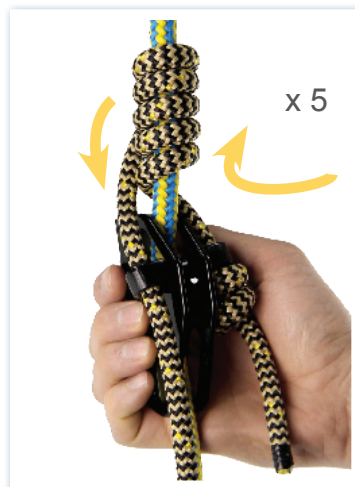

5 Tie another stopper knot, keeping the hitch as tight as possible.

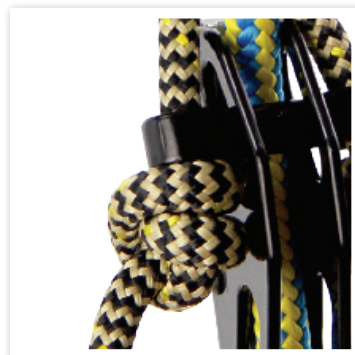

6 Insert the carabiner into the bottom slot, making sure the rope is between the spine and the carabiner.

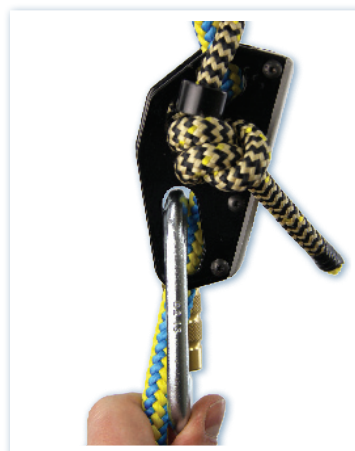

7 Put your full body weight on the carabiner and measure the distance from the final wrap of the hitch to the top of the hitchhiker; this should be 2" or less.

Incremental adjustments can be made to this distance by lengthening or shortening the final stopper knot. your cordage length, the taped end of the cord can be cut and whipped to your ideal length.

